

# 3 Way Faucet

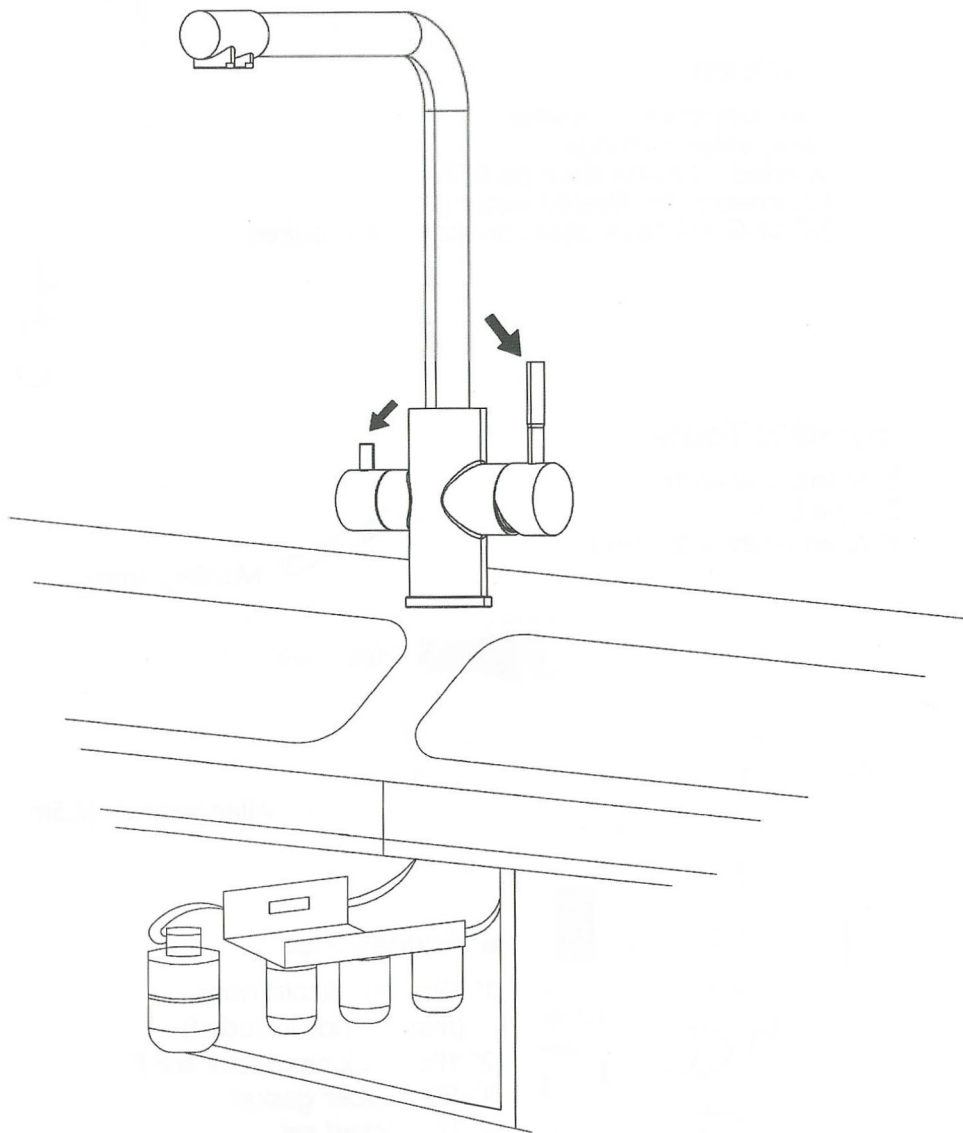

# Installation Instruction

## — 3 Way Faucet

### ● Specification

- 1' Surface treatment : Chrome
- 2' Ceramic valve cartridge
- 3' Flow rated : 2.2G/M base on 0.5Mpa
- 4' 1/4 connector for filtered water pipe
- 5' G-3/8 or G-1/2 hose pipe connector as required

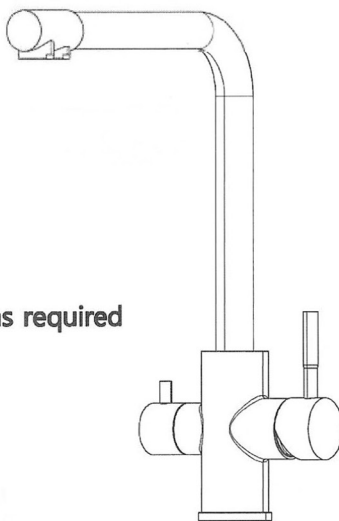

### ● Installing Tools

- 1' Monkey wrench
- 2' Pipe tape
- 3' Allen wrench (2.5mm)



Monkey wrench



Pipe tape



Allen wrench (2.5mm)

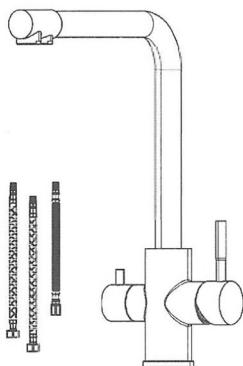

### ● Accessories

- 1' 2Pcs hot & cold hose  
(may be not included)
- 2' 1Pc quick connector for filter water hose
- 3' 1Pc rubber gasket
- 4' 1Pc locked set

# Profile Drawing

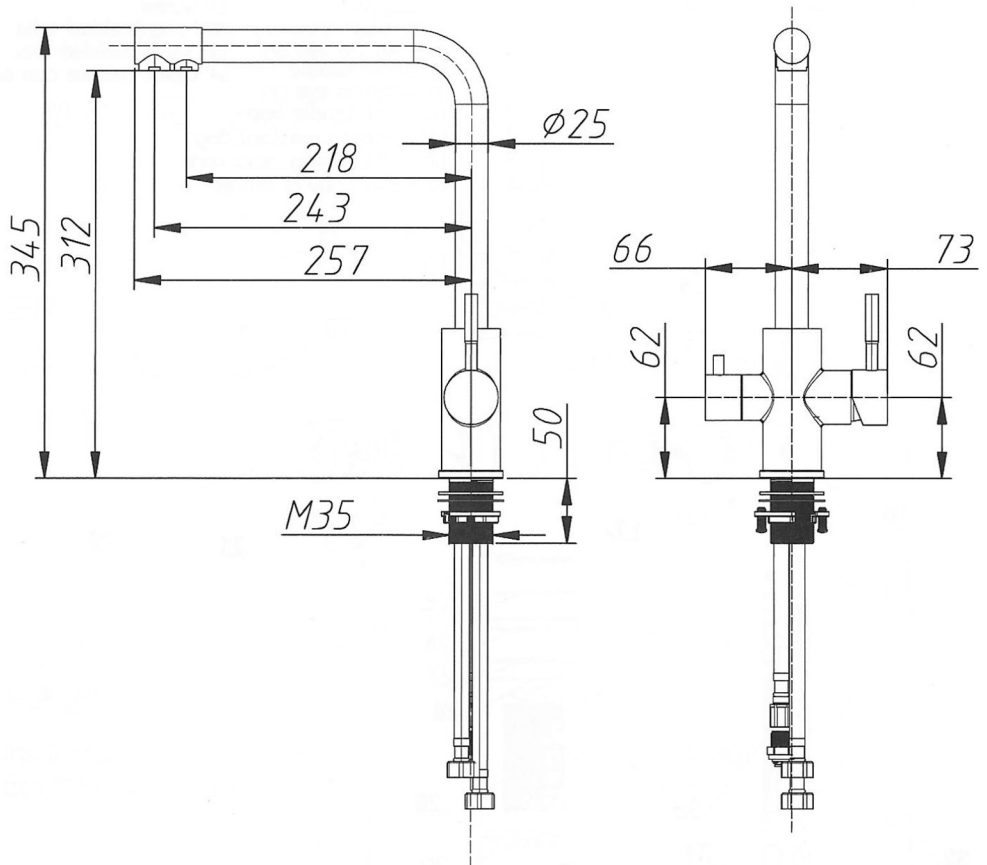

# Replacement Parts

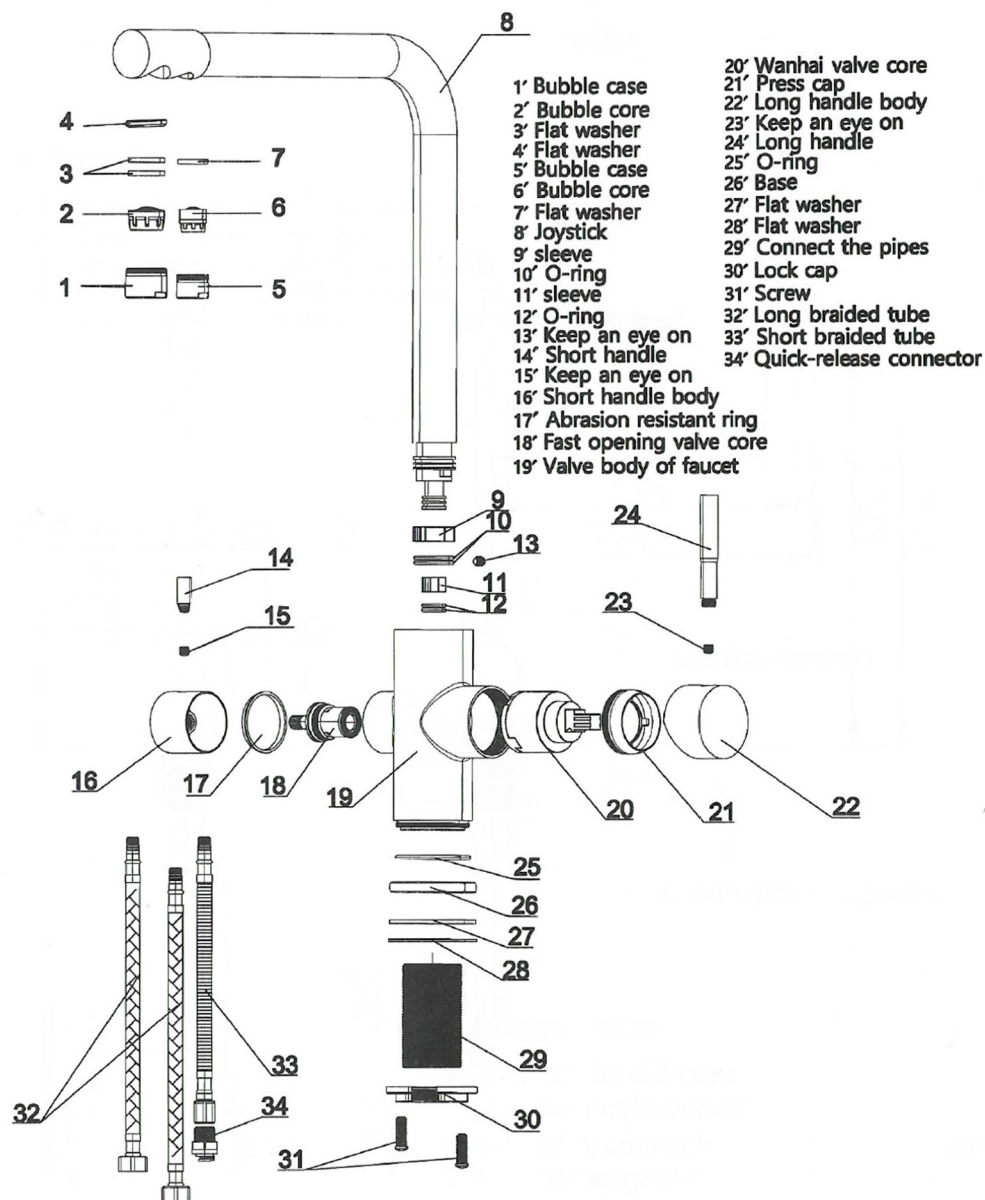

# Faucet

## Installation Procedures

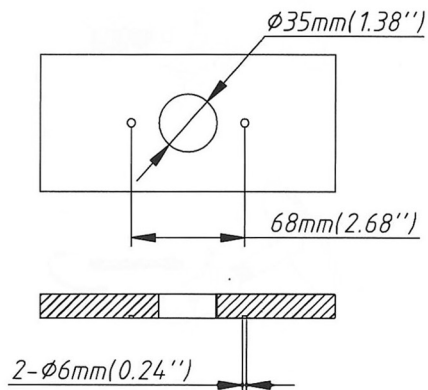

### STEP 1:

Please check cold&hot water and filter water channel first

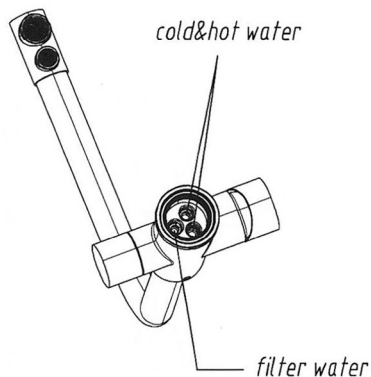

### STEP 2:

— fixed lock bolt

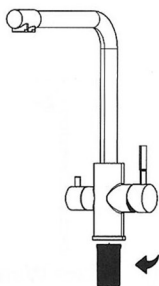

### STEP 3:

— installing cold&hot water hose

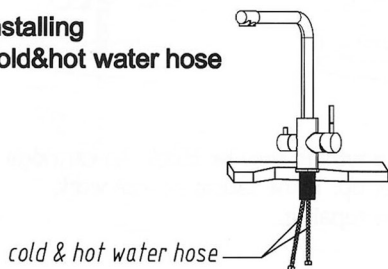

### STEP 4:

—installing filter water quick connector pipe

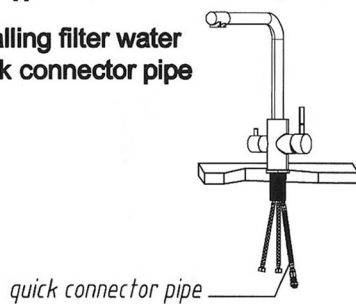

### STEP 5:

— fastened faucet by lock nut

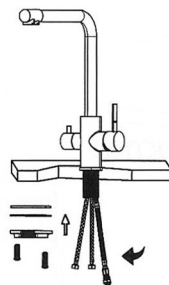

## STEP 6:

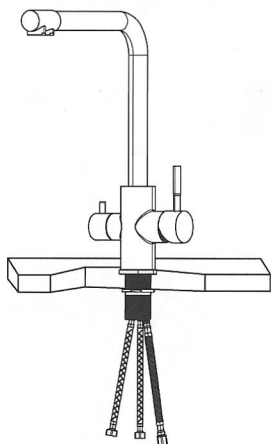

## STEP 7:

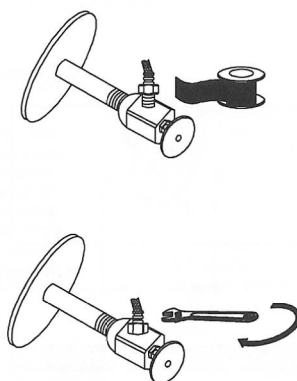

## STEP 8:

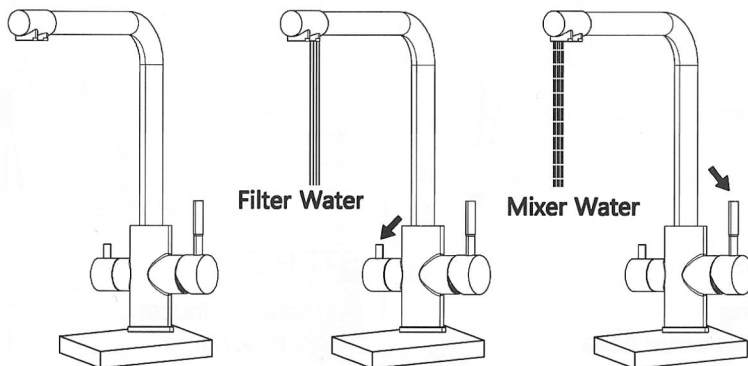

## NOTICE:

Please removal all the sand,silt etc.anything may be block the cartridge before fixed to your kitchen counter up. If the faucet cannot work, please send to a qualified person to repair it.

**STEP 9:**

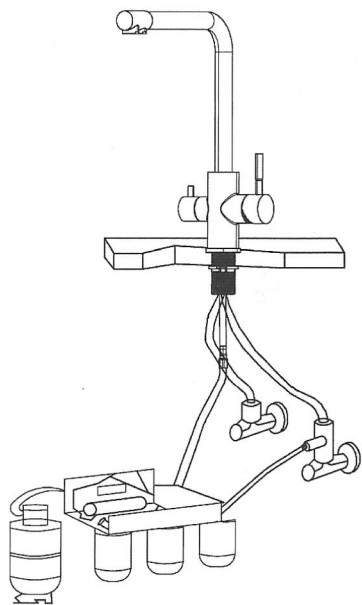

**STEP 10:**

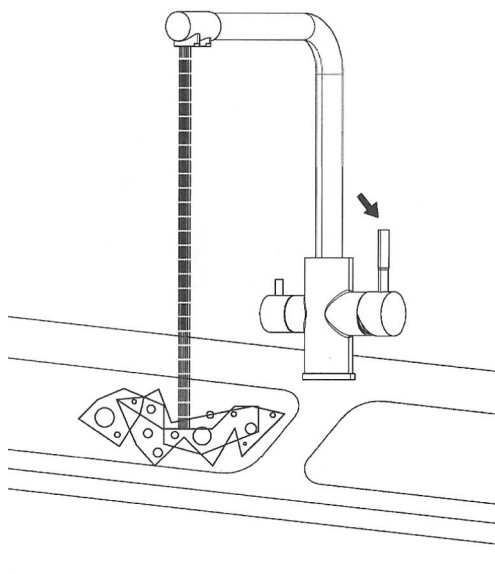

**STEP 11:**

